

SL-HB17-600-Far

Application

เหมาะสำหรับติดตั้งฟาร์มในร่ม และฟาร์มเดินท์

Specification

| | |
|-------------------------|--------------------------|
| Housing | Die-cast aluminium |
| Finishing | Powder coated in black |
| Lens | Polycarbonate |
| Gasket | Silicone rubber |
| Dimension | 454x298 mm. |
| Mounting | Hook or chain suspension |
| Power | 600W |
| Light Source | SMD LED Module |
| Light Colour | - |
| Efficiency | 2.0lm /W |
| Beam Angle | - |
| CRI , Ra | Ra>70 (> 80 Optional) |
| Input Voltage | 100-277VAC ,50/60Hz |
| IP Rate | IP65 |
| LED Lifetime | 50,000 hrs. |
| Control Optional | 1-10V , PWM |



3100.1955-2551



Dimension Drawing

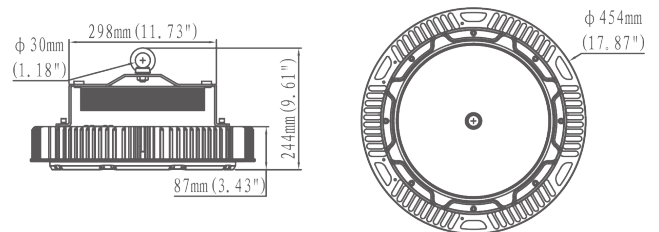

Ordering Data

| Model | Watt | CCT |
|-------------|------|-----|
| SL-HB17-600 | 600W | - |

Optimal Spectrum

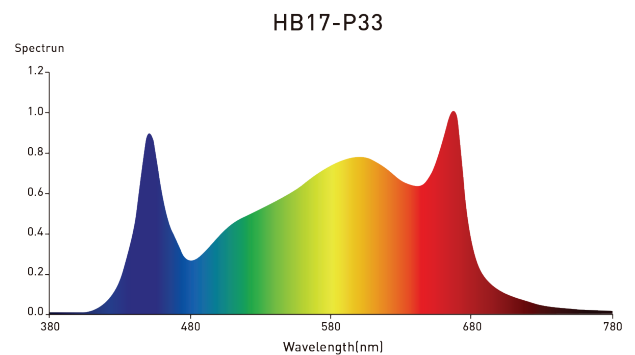

Related Optionals

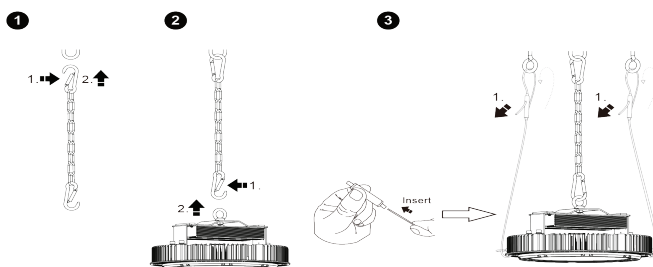

Applications

